

HUNTER Xci POLYISOCYANURATE USED AS AN AIR BARRIER INSTALLATION GUIDELINES



HUNTER
CONTINUOUS INSULATION

Outside/Inside Corners

XCI AB12

- 1 Verify sheathing has been properly installed. Report any deficiencies and ensure applicable repairs are conducted prior to Hunter Xci polyiso installation.
- 2 With factory edges exposed, stagger vertical joints at inside and outside corners, interlocking each row of Hunter Xci polyiso. Make sure the corners are straight and plumb. Use either the mechanical or adhesive attachment method outlined above.
- 3 Fill gaps between insulation boards with expanding spray foam or butter edge of board with approved sealant and strike flush. Expanding spray foam may also be applied onto the insulation board edges during installation. Ensure an airtight installation is achieved.
- 4 Apply approved adhesive extending the material a minimum of 1" beyond the edge of the approved flashing
- 5 Cut approved flashing to desired length and center over the Hunter Xci polyiso insulation board ensuring a minimum 3" bearing onto each side of the corner. Firmly roll the approved flashing with hand roller to strengthen adhesion.
- 6 Verify a continuous air seal at corners is achieved.

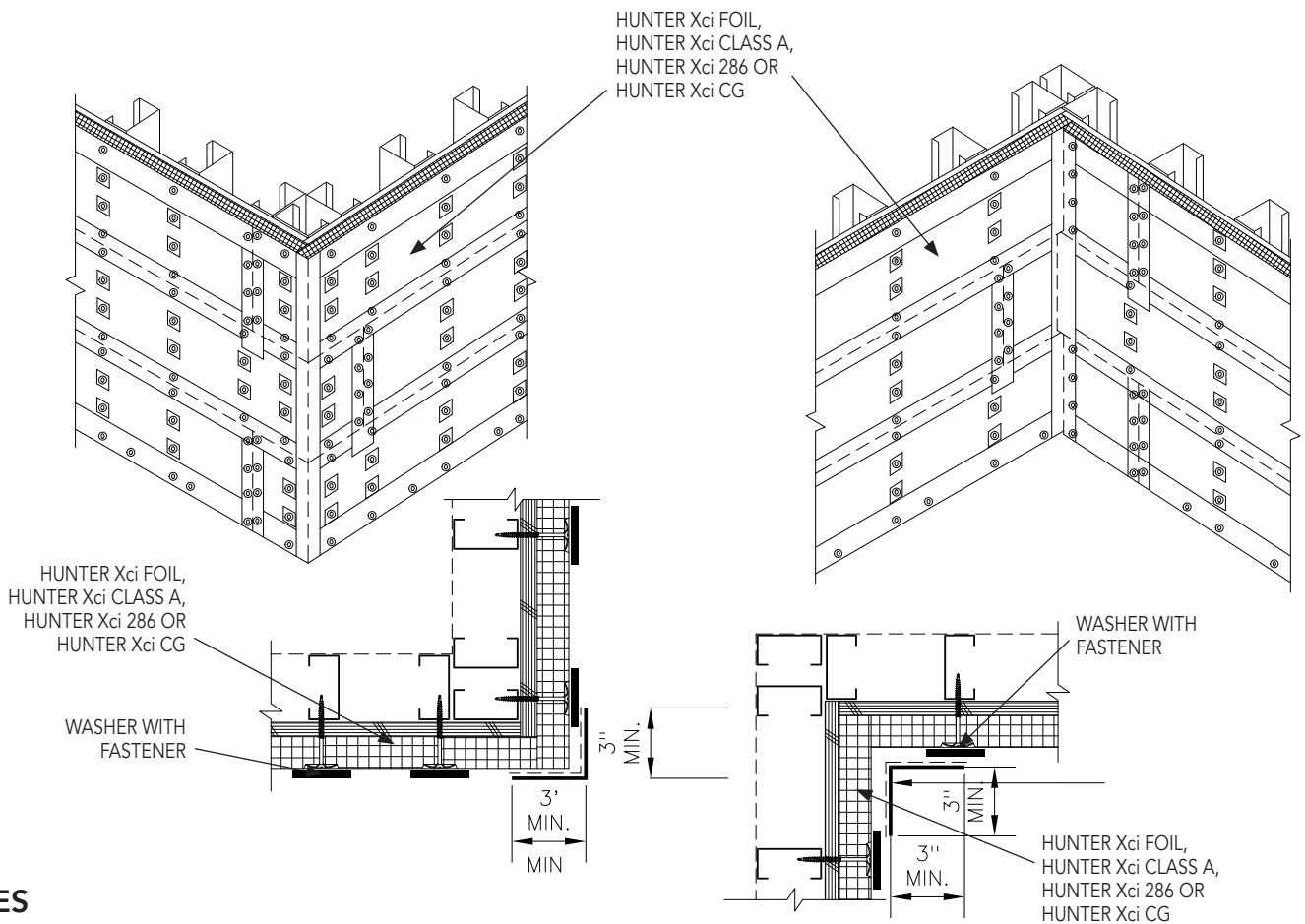

NOTES

- 1 Expansion joint placement and design is per the design professional.