



HUNTER Xci POLYISOCYANURATE USED AS AN AIR BARRIER INSTALLATION GUIDELINES

HUNTER
CONTINUOUS INSULATION

XCI AB2

4' x 8' Polyiso Insulation Adhesive Pattern

Installation of 4' x 8' Hunter Xci Polyiso Over Steel Stud/Standard or FRT Wood Framing with Exterior Gypsum/ Plywood/OSB Sheathing

- 1 Apply 3/8"-thick by 3" diameter dabs of approved adhesive to the back of Hunter Xci polyiso (side facing the sheathing) in 4 rows with a minimum of 7 dabs per row. Space adhesive dabs evenly across the length of the board at no more than 16" o.c. Space dabs in rows of no more than 16" o.c. and no more than 3" from board ends and edges. Immediately place insulation boards against the wall surface before adhesive Hunter Xci polyiso in 7 rows with a minimum of 4 dabs per row. Immediately place insulation boards against the wall surface before adhesive "skins. If adhesive skins, remove and apply fresh material. If Hunter Xci Polyiso is applied vertically, apply 3/8" by 3" diameter dabs of approved adhesive to the back of Hunter Xci polyiso in 7 rows with a minimum of 4 dabs per row following same requirements as above
- 2 Fill gaps between insulation boards with expanding spray foam or butter edge of board with approved sealant and strike flush. Expanding spray foam may also be applied onto the insulation board edges during installation. Ensure an air-tight installation is achieved.
- 3 Cut FOIL-GRIP 1402 to desired length and center over the joint ensuring a minimum 3" horizontal overlap and 5" vertical overlap, avoiding formation of wrinkles or bubbles. Firmly roll the FOIL- GRIP 1402 with hand roller to strengthen adhesion.
- 4 Sequence installation of FOIL-GRIP 1402 to form shingled laps.
- 5 Cut 4" x 4" square pieces of FOIL-GRIP 1402 and apply over insulation fasteners that have not been covered when treating the insulation board joints.
- 6 When applying veneer anchor brick-ties, FOIL-GRIP 1402 is applied under the brick-tie prior to mechanical installation.
- 7 Verify all materials are installed in accordance with current Hunter Panels published literature and local code requirements

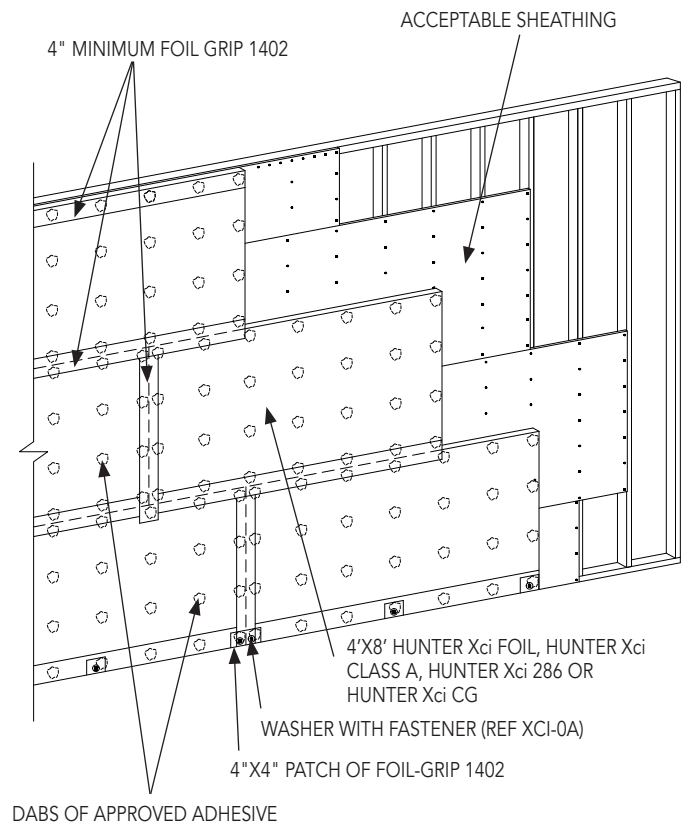

NOTES

- 1 3/8" thick by 3" diameter dabs of approved adhesive
- 2 Begin installation at base of wall from firm permanent or temporary support. Use washer with fasteners at base (Ref XCI 0A)
- 3 5" minimum vertical lap of FOIL-GRIP 1402, 3" minimum horizontal lap of FOIL-GRIP 1402