



# HUNTER Xci POLYISOCYANURATE OVER AIR/VAPOR BARRIER INSTALLATION GUIDELINES

HUNTER  
CONTINUOUS INSULATION

## XCI 1

### 4'x8' Polyiso Insulation Fastener Pattern

#### Installation of 4' x 8' Hunter Xci Polyiso Over Steel Stud/Standard or FRT Wood Framing with Exterior Gypsum/ Plywood/OSB Sheathing and Air/Vapor/ Water Resistive Barrier

- 1 Begin at base of wall from firm, permanent, or temporary support.
- 2 Apply Hunter Xci polyiso horizontally in a running bond pattern using maximum board lengths to minimize number of joints. Offset Hunter Xci polyiso board joints minimum 6". Hunter Xci polyiso may be applied vertically as required.
- 3 Pre-cut Hunter Xci polyiso to fit openings and projections. Stagger vertical joints and corners. Stagger insulation and sheathing board joints minimum 6". Hunter Xci polyiso insulation boards are cut with a knife using a square to guide the cut or table saw.
- 4 Abut all joints tightly and ensure overall flush, level surface.
- 5 Fasten Hunter Xci polyiso insulation board to steel framing member with appropriate length fastener min. 4 threads of the fastener into steel framing, min. 1" into wood framing. Space fasteners 12" o.c. at perimeter and 16" o.c. in the field. Set back perimeter fasteners 3/8" from board edges and end. One washer may be used to bridge adjoining boards. Drive fasteners so that washer is tight and flush with the surface of the Hunter Xci polyiso, but do not over-tighten.

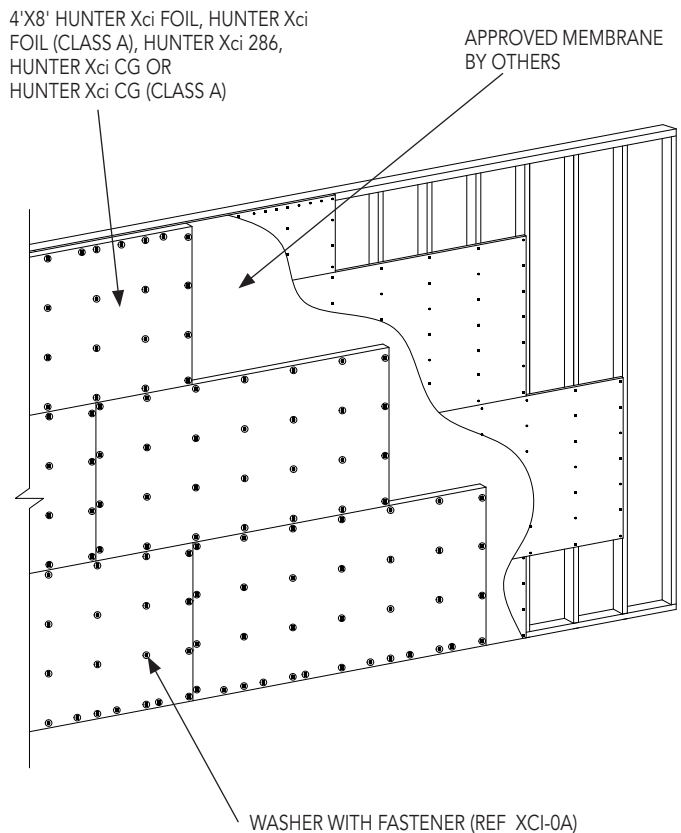

## NOTES

- 1 Install approved fasteners (ref XCI-OA) 16" O/C along Stud Line and 12" O/C on perimeter.
- 2 Adhesive may be used as a placement aid to facilitate installation