

16" or 24" Polyiso Insulation with Brick-Ties
Installation of 16" x 8' or 24" x 8' Hunter Xci Polyiso Over Steel Stud/Standard or FRT Wood Framing with Exterior Gypsum/Plywood/OSB Sheathing and Air/Vapor/ Water Resistive Barrier with Brick-Ties already in place

XCI 4

- 1 Apply 3/8"-thick by 3" diameter dabs of approved adhesive to the back of Hunter Xci polyiso (side that will face sheathing) in 2 rows with a minimum of 7 dabs per row. Space adhesive dabs evenly across the length of the board at no more than 16" o.c. Space dabs in rows of no more than 16" o.c. (12" o.c. for 16"-wide Hunter Xci polyiso) and no more than 3" from board ends and edges. Immediately place insulation boards against the wall surface before adhesive "skins" form. If adhesive "skins" form, remove and apply fresh material.
- 2 Fill gaps greater than 1/8" between insulation boards with expanding spray foam or butter edge of board with approved sealant and strike flush. Expanding spray foam may also be applied onto the insulation board edges during installation.
- 3 Verify all materials are installed in accordance with current Hunter Panels published literature and local code requirements.

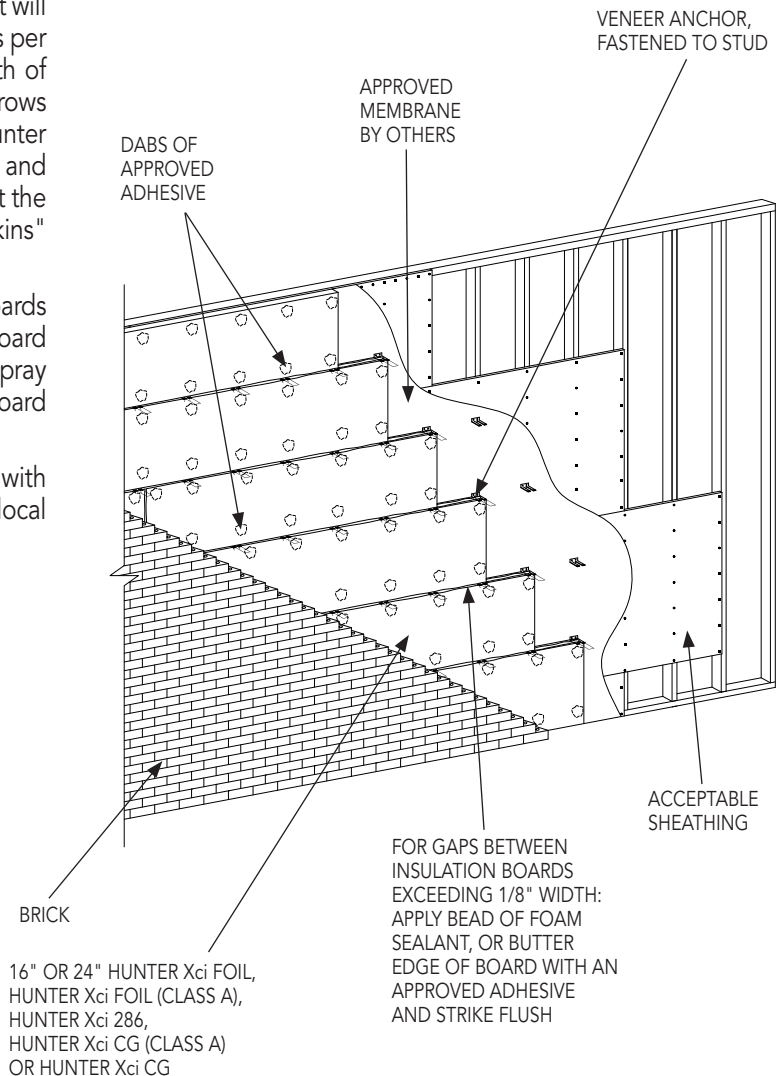

NOTES

- 1 Follow Brick Tie Manufacturer insulation instructions