



HUNTER
CONTINUOUS INSULATION

Hunter Panels Xci CG

Polyisocyanurate Insulation Manufactured On-Line to Premium Performance
Coated Glass Facers for Residential and Light Commercial Application

DESCRIPTION

Xci CG is a high-thermal rigid insulation panel composed of a closed cell polyisocyanurate foam core manufactured on-line to premium performance coated glass facers on both sides. It is designed for use in wall applications to provide continuous insulation within the building envelope.

PREMIUM PERFORMANCE ATTRIBUTES

- Polyiso offers increased R-value per inch vs mineral fiber, XPS or EPS options
- Meets the new minimum continuous insulation standards prescribed in ASHRAE 90.1-2010 and IECC 2012
- Manufactured with NexGen Chemistry: Contains no CFCs, HCFCs, is Zero ODP, and has virtually no GWP
- Provides superior dimensional stability, fire performance and resistance to mold growth

APPLICATIONS

- Provides continuous insulation (ci) in new construction for standard wood frame, steel stud, CMU and masonry cavity exterior walls
- Exterior retrofit applications of existing walls
- Interior retrofit of existing walls or ceilings in concealed applications when protected by code-approved 15-minute thermal barrier
- Xci CG is compatible with wood, vinyl, fiber cement, aluminum, or hardboard sidings in wood frame construction

Note: Xci CG is not suitable for exposed interior applications.

PANEL CHARACTERISTICS

- ASTM C 1289 Type II, Class 2. Grade 1, 2 or 3 available.
- Available in 4' x 8' (1220mm x 2440mm) panels in thicknesses of 0.5" (12.7mm) – 4" (102mm)
- Other sizes are available upon special request – (for example: 16" or 24" width)

CODES AND COMPLIANCES

- ASTM C1289, Type II, Class 2
- International Residential Code (IRC) and International Building Code (IBC)
- NFPA 285 Passed, contact Hunter Panels for more information
- DRJ Technical Evaluation Report 1402-02
- Miami Dade County Product Control Approved
- ICC-ESR-3174
- UL Classified for use in Canada
– Refer to UL Director of Products Certified for Canada for more details
- CCMC 13460-L
- CAN/ULC S-704 Type 2, Class 2

WRB

The incorporation of Weather Resistant Barriers (air, vapor and moisture) is a critical element of a wall assembly. A design professional familiar with local code requirements should specify the selection and placement of any WRB. Furthermore, it is recommended that a hygrothermal analysis of the proposed assembly be conducted to determine the type and locations of a proposed WRB.

HUNTER PANELS Xci CG

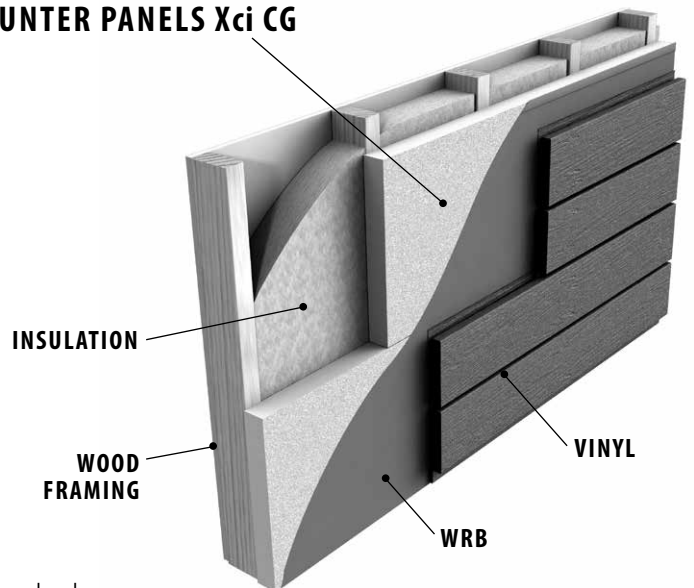

Xci CG Thermal Values

Thickness (inches)	Thickness (mm)	R-Value*
0.50	12.7	3.0
0.75	19	4.5
1.0	25	6.0
1.5	38	9.0
2.0	51	12.1
2.5	64	15.3
3.0	76	18.5
3.3	84	20.4
3.5	89	21.7
4.0	102	25.0

*Initial thermal values are determined by using ASTM C 518 at 75° F mean temperature.



Residential/Light Commercial

Hunter Panels Xci CG

Polyisocyanurate Insulation Manufactured On-Line to Premium Performance
Coated Glass Facers for Residential and Light Commercial Application

WARNINGS AND LIMITATIONS

Insulation must be protected from open flame. Hunter Panels will not be responsible for specific building design by others, for deficiencies in construction or workmanship, for dangerous conditions on the job site or for improper storage and handling. Technical specifications shown in this literature are intended to be used as general guidelines only and are subject to change without notice. Call Hunter Panels for more specific details.

INSTALLATION

- Xci CG is not a structural sheathing, code approved shear or corner bracing is required
- Exterior cladding must be attached through the insulation to the framing
- For wood framing, secure boards with $\frac{3}{8}$ " head diameter galvanized roofing nails which must penetrate the stud at least $\frac{3}{4}$ " or use 1" crown 16 gauge staples which penetrate framing $\frac{1}{2}$ "
- Fasten insulation to framing every 12" around the perimeter and every 16" in the field
- Refer to local codes and practices for placement of the WRB in the wall assembly
- Exterior siding can be installed over Xci CG. Refer to the siding manufacturer's installation instructions.

POST-INSTALLATION EXPOSURE

During the time frame between installation of Xci CG and the application of the finished exterior cladding, it is recommended that a building wrap be applied to the Xci CG. If a building wrap has not been specified, ALL UNFACED FOAM EXPOSED TO DIRECT DAYLIGHT (i.e. corners, window and door openings) should be taped with a compatible waterproof tape. Xci CG is not intended to be left exposed for extended periods of time (i.e. in excess of 60 days) without adequate protection. Please contact Hunter Panels for details.

JOB-SITE STORAGE

Good construction practice dictates that all insulations should be protected from moisture and direct sunlight during job-site storage. Pallets of Hunter Panels Xci CG are double packaged in a UV resistant polyethylene bag. This moisture resistant package is designed for protection from the elements during flat bed shipment from our factories to the job-site. Outdoor storage for extended periods of time requires additional waterproof tarpaulins and elevated storage above ground level a minimum of 2".

Typical Physical Property Data Chart polyiso foam core only		
Property	Test Method	Value
Compressive Strength	ASTM D 1621	20 psi* min. (138 kPa, Grade 2)
Dimensional Stability	ASTM D 2126	2% linear change (7 days)
Moisture Vapor Permeance	ASTM E 96	<1 perm (57.5ng/(Pa·s·m ²))
Water Absorption	ASTM C 209	< 0.1% volume
Service Temperature		-100° to 250° F (-73°C to 122°C)
Resistance to Mold	ASTM D 3273	Passed (10)

*Also available in Grade 1 (16 psi) or Grade 3 (25 psi)



HUNTER
CONTINUOUS INSULATION

888.746.1114

www.hunterpanels.com



LEED POTENTIAL CREDITS FOR POLYISO USE

Energy and Atmosphere

- Optimize Energy Performance

Materials & Resources

- Building Life-Cycle Impact Reduction
- Environment Product Declaration
- Material Reuse • Recycled Content
- Construction and Demolition Waste Management

Indoor Environmental Quality

- Thermal Comfort

Residential/Light Commercial

HUNTER PANELS • Energy Smart Polyiso

NEW YORK

ILLINOIS

FLORIDA

TEXAS

UTAH

PENNSYLVANIA

WASHINGTON